

# 925-80x

Lv7 2022-r1

Modelo-model:

**CRUZ Airo**

Lote-Lot-Lot-Lot:



Peso-Weight-Poids-Gewicht:

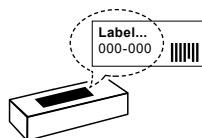

Kit A: **Max. 50 kg**  
Kit B: **Max. 60 kg**  
Kit C,D,E: **Max. 75 kg**  
Kit R: **Max. 75 kg**

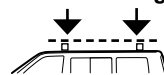

CEE - EEC type approval:



26 R- 04 3040

- (E)** **Instrucción de montaje**  
¡Leer primero!
- (GB)** **Assembly instructions**  
Read first!
- (F)** **Instruction de montage**  
Lire en premier!
- (D)** **Montageanleitung**  
Zuerst lesen!
- (PT)** **Instruções de montagem**  
Ler primeiro!
- (PL)** **Instrukcja montażu**  
Najpierw przeczytaj!
- (CZ)** **Montážní návod**  
Čtěte pozorně!
- (HU)** **Szerelési Utasítás**  
Először olvasd el!
- (RO)** **Instructiuni de montaj**  
Intai cititi!
- (HR)** **Detaljne upute**  
Prvo procitati!
- (GR)** **Διαβάστε προσεκτικά τις**  
Οδηγίες Συναρμολόγησης!
- (TR)** **Öncelikle montaj:**  
Talimatlarını okuyunuz!
- (RU)** **Инструкции по монтажу**  
Сначала прочитайте!
- (I)** **Istruzioni di montaggio**  
Leggere per primo!
- (NL)** **Montagehandleiding**  
Eerst lezen!
- (SLO)** **Navodila za sestavljanje**  
Preberite!

Barras de aluminio  
Aluminium bars  
Barres d'aluminium  
Aluminiumdachträger  
Barras d'alumínio  
Belki aluminiowe  
Hliníková sada tyčí  
Aluminium rudak  
Aluminijske šipke  
Bare din aluminiu  
Μπάρες Αλουμινίου  
Alüminyum barlar  
Алюминиевые поперечины  
Barre di alluminio  
Aluminium dakdragers  
Aluminijske prečke



**CITY CRASH** (↻)

CRUZBER SAU  
ES-A14018311  
P.I. Las Salinas II  
14960 - Rute - Spain  
www.cruzber.com



1.

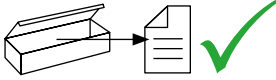

(E) Contenido embalaje: ¡Verificar!

x1

x1

(GB) Package content: Check!

(F) Contenu d'emballage: Vérifier!

(D) Packungsinhalt: Überprüfen!

(PT) Contéudo embalagem:  
Verificar!

(PL) Zawartość opakowania:  
sprawdź!

(CZ) Obsah balení: Zkontrolujte!

(HU) Csomag tartalma: Ellenőrizd!

(RO) Pachetul contine: Verificati!

(HR) Sadržaj paketa: Provjeri!

(GR) Ελέγξτε το περιεχόμενο: του  
πακέτου!

(TR) Paket içeriğini: Control ediniz!

(RU) Содержание упаковки:  
Проверьте!

(I) Contenuto della confezione:  
Controllare!



(NL) Pakket inhoud: Controleer!

(SLO) Vsebina paketa: Preverite!

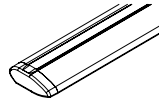

x2

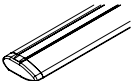
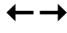

Código Code					Lote Lot
925-801	CRUZ Airo 108	108 cm	2x (012-151) 1x (012-152)	2.86 Kg	01/22
925-803	CRUZ Airo 118	118 cm		3.05 Kg	01/22
925-805	CRUZ Airo 128	128 cm		3.30 Kg	01/22
925-806	CRUZ Airo 133	133 cm		3.40 Kg	01/22
925-807	CRUZ Airo 138	138 cm		3.49 Kg	01/22

## 2.



**Importante!  
Important!  
Important!  
Wichtig!**

- (E)** Estas barras tienen que usarse con Kits de fijación Cruz!
- (GB)** Bars must be used with Cruz fixation Kits!
- (F)** Les barres devront être utilisées avec les Kits de fixation Cruz!
- (D)** Die Dachlsträger nur mit Cruz Stützfuß-Kits befestigen!
- (PT)** As barras devem ser utilizadas com os Kits de fixação Cruz!
- (PL)** Belki muszą być stosowane z elementów mocującymi firmy Cruz!
- (CZ)** Tento nosič musí být používán s fixačním kitem Cruz!
- (HU)** A rudákat csak Cruz rögzítő készlettel szabad használni!
- (RO)** Barele trebuie utilizate cu Kit-uri de fixare Cruz!
- (HR)** Šipke moraju biti korištene sa Cruz kitovima za montažu!
- (GR)** Το αξεσουάρ αυτό θα πρέπει να χρησιμοποιείται αποκλειστικά στα συστήματα μπαρών της Cruz!
- (TR)** Bu barlar mutlaka Cruz montaj kiti!
- (RU)** Поперечины должны быть использованы со специальным крепежным комплектом Cruz!
- (IT)** Questa bare deve essere utilizzato solo con il kit di fissaggio Cruz!
- (NL)** Dakdragers moeten worden gebruikt in combinatie met de bevestigingssets van Cruz!

1

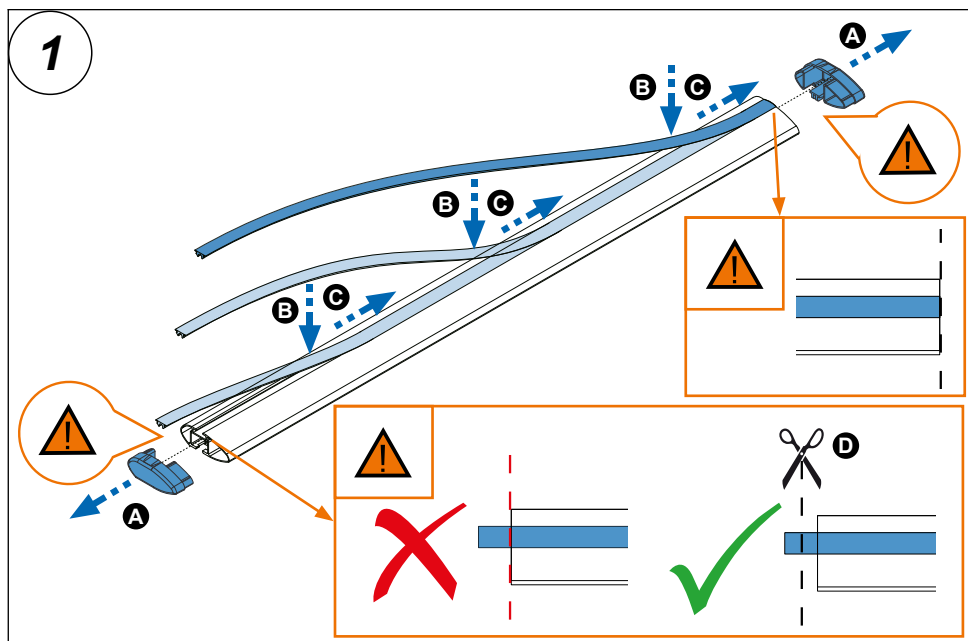

2



**JUEGO DE PIES  
DE FIJACION**

